



HH-x6P Remote Control Unit Manual
HH-x6P-LED Remote Control Unit
Manual

DN: U131.2.0-SmaRT_HH-x6P

This document is the property of Cervis, Inc. and cannot be copied, modified, e-mailed, or reproduced without the express prior written consent of Cervis, Inc.

Cervis, Inc. reserves the right to change this manual or edit, delete, or modify any information without prior notification.

FCC Statements

15.19 – Two Part Warning

This device complies with Part 15 of the FCC rules. Operation is subject to the following two conditions:

- (1) This device may not cause harmful interference and
- (2) This device must accept any interference received, including interference that may cause undesired operation.

15.21 – Unauthorized Modification

NOTICE: The manufacturer is not responsible for any unauthorized modifications to this equipment made by the user. Such modifications could void the user's authority to operate the equipment.

15.105(b) – Note:

This equipment has been tested and found to comply with the limits for a Class B digital device, pursuant to Part 15 of the FCC Rules. These limits are designed to provide reasonable protection against harmful interference in a residential installation. This equipment generates, uses and can radiate radio frequency energy and, if not installed and used in accordance with the instructions, may cause harmful interference to radio communications. However, there is no guarantee that interference will not occur in a particular installation. If this equipment does cause harmful interference to radio or television reception, which can be determined by turning the equipment off and on, the user is encouraged to try to correct the interference by one or more of the following measures:

- Reorient or relocate the receiving antenna.
- Increase the separation between the equipment and receiver.
- Connect the equipment into an outlet on a circuit different from that to which the receiver is connected.

Industry Canada Statement

This device complies with Canadian RSS-210.

The installer of this radio equipment must ensure that the antenna is located or pointed such that it does not emit RF field in excess of Health Canada limits for the general population; consult Safety Code 6, obtainable from Health Canada's website <https://www.canada.ca/en/health-canada/services/environmental-workplace-health/reports-publications/radiation/safety-code-6-health-canada-radiofrequency-exposure-guidelines-environmental-workplace-health-health-canada.html>.

Le présent appareil est conforme à la norme CNR-210 d'Industrie Canada.

Le programme d'installation de cet équipement radio doit s'assurer que l'antenne est située ou fait telle qu'elle n'émet pas de champ RF dépassant les limites de Santé Canada pour la population générale ; consulter le Code de sécurité 6, disponible auprès de Santé Canada site Web <https://www.canada.ca/en/health-canada/services/environmental-workplace-health/reports-publications/radiation/safety-code-6-health-canada-radiofrequency-exposure-guidelines-environmental-workplace-health-health-canada.html>.

Industry Canada Statement

This device complies with Industry Canada licence-exempt RSS standard(s). Operation is subject to the following two conditions: (1) this device may not cause interference, and (2) this device must accept any interference, including interference that may cause undesired operation of the device.

Le présent appareil est conforme aux CNR d'Industrie Canada applicables aux appareils radio exempts de licence. L'exploitation est autorisée aux deux conditions suivantes : (1) l'appareil ne doit pas produire de brouillage, et (2) l'utilisateur de l'appareil doit accepter tout brouillage radioélectrique subi, même si le brouillage est susceptible d'en compromettre le fonctionnement.

RoHS Compliance Statement

Cervis, Inc. complies with the requirements of **Restriction of Hazardous Substances (RoHS/WEEE) Specification** based on in-house practice and declaration of compliance from our vendors. For additional information concerning RoHS compliance, please contact Cervis, Inc. at:

CERVIS, Inc.

170 Thorn Hill Road • Warrendale, PA 15086

Phone: 724.741.9000 • Fax: 724.741.9001



This product may contain material that may be hazardous to human health and the environment. In compliance with EU Directive 2002/96/EC on Waste Electrical and Electronic Equipment (WEEE):

- ✓ Do not dispose of the product as unsorted municipal waste.
- ✓ This product should be recycled in accordance with local regulations. Contact local authorities for detailed information.
- ✓ This product may be returnable to the distributor for recycling. Contact your distributor for details.

Notes/Definitions

Associate

SmaRT configuration method using a series of specific remote unit button presses to establish a communication link between a SmaRT Remote Control Unit and a SmaRT Base Unit.

Dissociate

Dissolution of established communication links between remote control units and base units involved in the process.

DSSS

Direct sequence spread spectrum; an advanced wireless communication technology.

Line of Sight (aka Direct-Line-of-Sight)

Type of communication between transceivers, or a transmitter and a receiver, where the pathway between the two units must be clear of obstacles.

Tandem

Mode of communication between one instigator and two sympathizers. Also referred to as 1:2 communication.

TX/RX

Transmit/Receive

Document Conventions

✓ **Note:** Notes are used to indicate points of interest or pertinent information.

CAUTION



Cautions are used to warn of serious consequences of actions or inactions that may result in injury, death, or serious damage to the equipment.

Table of Contents

Notes/Definitions	i
Document Conventions.....	i
Table of Contents.....	ii
List of Figures	ii
List of Tables	ii
Cervis, Inc. Safety Precautions	1
1.0 Smart HH-x6P Remote Control Unit.....	2
2.0 Remote Control and Base Unit Communication.....	3
2.1 Associate HH-x6P Remote Control to Base Unit.....	3
2.2 Dissociate HH-x6P Remote Control from Base Unit	4
3.0 Battery Installation or Change.....	5
4.0 Using a Standard Smart Remote Control Unit.....	6
5.0 Low Battery Warning and Low Battery Auto-Shutdown	7
6.0 Specifications.....	8
7.0 Spare Parts List.....	9
Appendix A: Exposure to Radio Frequency Energy.....	10
Appendix B: Agency Identification Label Locations	10

List of Figures

Figure 1 Associate a HH-x6P Remote Control to a Base Unit	3
Figure 2 Dissociate a HH-x6P Remote Control from a Base Unit.....	4
Figure 3 Remote Control Battery Installation.....	5
Figure 4 Remote Low Battery Warning and Auto-Shutdown.....	7
Figure 5 Agency Identification Label Locations	10

List of Tables

Table 1 HH-x6P Remote Control Options	2
Table 2 Smart HH-x6P Remote Control Unit Specifications	8
Table 3 Spare Parts List	9

Cervis, Inc. Safety Precautions

- ✓ **Read and follow all instructions.**
- ✓ **Failure to abide by Safety Precautions may cause equipment failure, loss of authority to operate the equipment, and personal injury.**
- ✓ **Use and maintain proper wiring. Follow equipment manufacturer instructions. Improper, loose, and frayed wiring can cause system failure, equipment damage, and intermittent operation.**
- ✓ **Equipment changes or modifications not expressly approved by the manufacturer will void the warranty.**
- ✓ **Equipment owner/operators must abide by all applicable Federal, State, and Local laws concerning equipment installation and operation. Failure to comply could result in penalties and could void user authority to operate the equipment.**
- ✓ **Make sure that the machinery and surrounding area is clear before operating. Do not activate the remote control system until you are certain that it is safe to do so.**
- ✓ **Turn off the remote control and disconnect power from the base unit before attempting any maintenance. This will prevent accidental operation of the controlled machinery.**
- ✓ **Power can safely be disconnected from the remote by removing the source power (batteries) from the unit.**
- ✓ **Power can be removed from the base unit by disconnecting the source power from the circuit.**
- ✓ **Use a damp cloth to keep units clean. Remove mud, concrete, dirt, etc. after use to prevent obstructing or clogging the buttons, levers, wiring, and switches.**
- ✓ **Do not allow liquid to enter the remote control or base unit enclosures. Do not use high-pressure equipment to clean the remote control or base unit.**
- ✓ **Disconnect the base unit before welding on the machine. Failure to disconnect the base unit may cause destruction of or damage to the base unit.**
- ✓ **Operate and store units only within the specified operation and storage temperatures defined in this document's Specifications.**

1.0 smaRT HH-x6P Remote Control Unit

Remote Control Features

- ✓ License-free 900 MHz or 2.4 GHz Direct Sequence Spread Spectrum Technology (DSSS)
- ✓ Direct-line-of-sight communications up to 650 ft. (~200 m) range
- ✓ Powered by two AAA cell batteries
- ✓ Low Battery Warning and Low Battery Auto-Shutdown
- ✓ Discrete ON and OFF buttons
- ✓ Six proportional buttons
- ✓ Diagnostic light-emitting diode (LED) indicators
- ✓ Rugged high-impact polymer enclosure; compact weatherproof design
- ✓ Removable rubber bumper and detachable lanyard or belt clip
- ✓ Operating temperature: -4° F to +131° F (-20° C to +55° C)

The HH-x6P-LED or HH-x6P remote control unit has individual ON and OFF buttons and six proportional control buttons. The remote control has an automatic shutdown timeout—a period after which the remote turns itself off to conserve power if no function buttons are pushed. Each proportional button can be assigned to provide standard or customized activation of base unit outputs. This allows for maximum flexibility while programming to interface with the wide array of available smaRT base units.

The HH-x6P-LED and HH-x6P remote control can communicate with a wide variety of smaRT base units using Channel-Hopping Direct Sequence Spread Spectrum (DSSS) wireless technology at 2.4 GHz or 900 MHz. It offers a robust link with a base unit in congested radio environments. smaRT remote control units feature seamless association with smaRT base units without needing to open either the remote control or base unit cases.

Two size “AAA” cell batteries power the smaRT HH-x6P-LED and HH-x6P, operating between 2.0 VDC to 3.2 VDC. Six visible status/diagnostic LEDs indicate transmit (**TX**) and receive (**RX**) activity, communications errors (**ERR**), and low battery (**BAT**) warning. Two additional LEDs—**A1** and **A2**—offer custom-programmed auxiliary status indications. There are an additional six LEDs available for custom programming with the HH-x6P-LED.

The weatherproof remote control enclosure is made of rugged high-impact plastic with a face plate securely sealed and attached by eight screws. It is further protected by a removable rubber bumper that covers the unit’s back and sides. A lanyard that can be attached to the unit through a recess on the bottom of the rubber bumper is available; or the unit can be ordered with a convenient belt clip.

HH-x6P Remote Control Remote Options

Table 1 HH-x6P Remote Control Options

Model Name	Part #	Freq.	RF Power	Proportional Inputs	Proportional Input Type	Digital Inputs	LED Count
HH-2H6P-LED	21008501	2.4GHz	100 mW	6	FSR Membrane	2	12
HH-9X6P-LED	21008502	900MHz	100 mW	6	FSR Membrane	2	12
HH-2H6P	07117502	2.4GHz	100 mW	6	FSR Membrane	2	6
HH-9X6P	07117512	900MHz	100 mW	6	FSR Membrane	2	6
HH-9X6PT ¹	07117514	900MHz	100 mW	6	FSR Membrane	2	6

¹ Tandem 1:2 Operation Capable

2.0 Remote Control and Base Unit Communication

2.1 Associate HH-x6P Remote Control to Base Unit

An HH-x6P remote control unit must establish a communications link with a base unit before it can be used for control. An HH-x6P remote (as part of a system) is associated with the system base unit before leaving Cervis, Inc. But, it is possible to associate an HH-x6P in the field either to address a communication problem or to add or replace a remote control unit. The procedure to establish the link is called "Association."

In situations where it is necessary to establish or re-establish remote control-to-base unit communications, use the following steps:

1. Stand near the base unit with the remote control **OFF** and **power removed** from the base unit.
2. Push and hold the **B1** and **B2** buttons for approximately two seconds. The **A1**, **A2**, and **TX** LEDs light. Release the **B1** and **B2** buttons.
3. Press and hold button **B1**. Turn base unit power on. Release button **B1** when base unit powers up.

The remote control and base unit are connected when both the **TX** and **RX** LEDs on both devices start blinking simultaneously as messages pass between them. The SmaRT system is ready for use.

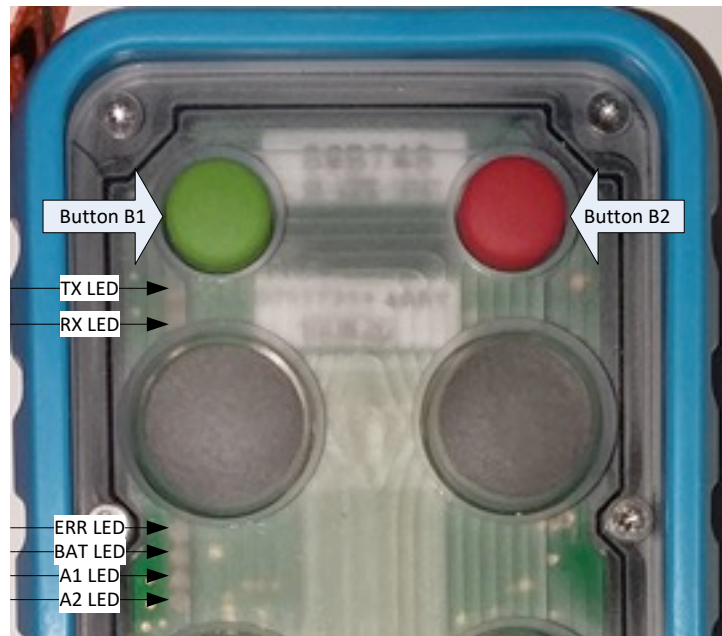

Figure 1 Associate a HH-x6P Remote Control to a Base Unit

2.2 Dissociate HH-x6P Remote Control from Base Unit

In some circumstances, it may become necessary to break the communication link, or “dissociate” a remote control and a base unit. The dissociate procedure is almost identical to the associate procedure, except the dissociate button (**B2**) is used and held throughout the process instead of the Associate button (**B1**).

CAUTION



Any handhelds already associated to the base unit will no longer be associated if a dissociate procedure is performed by any handheld.

1. Stand near the base unit with the remote control **OFF** and **power removed** from the base unit.
2. Push and hold the **B1** and **B2** buttons for approximately two seconds. The **A1**, **A2**, and **TX** LEDs light. Release buttons **B2** and **ON**.
3. Press and hold button **B2**. Turn base unit power on. Release button **B2** when base unit powers up.
4. Remote control and base unit are disconnected when the **TX** LED (only) starts blinking.

Established links with base units are removed. To re-establish a communication link with a base unit, use the Associate Procedure (Section 2.1).

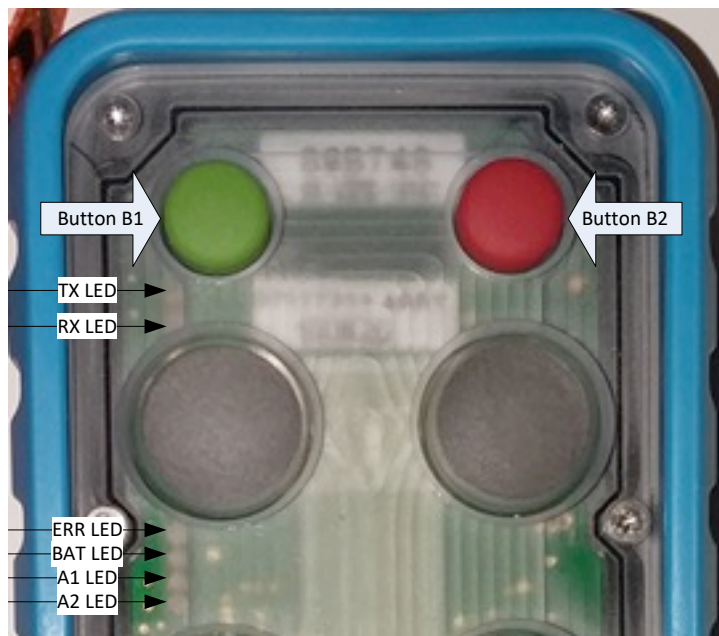

Figure 2 Dissociate a HH-x6P Remote Control from a Base Unit

3.0 Battery Installation or Change

Two size “AAA” cell batteries power SmARt HH-x6P remote control units. When installing batteries, be sure to observe proper polarity—as marked on the inside of the compartment—to avoid damaging the unit.

To replace or install remote control batteries:

1. Loosen the four small Phillips screws on the battery compartment cover, and lift the cover from the remote control. The screws remain attached to the cover.
2. If installing batteries in an empty battery compartment, install two fresh size “AAA” cell batteries. Be sure to position the batteries as illustrated in Figure 3 below.
3. If replacing expired batteries, remove the old batteries, and install two fresh size “AAA” cell batteries. (Discard the used batteries according to local regulations.) Be sure to position the batteries as illustrated in Figure 3 below.
4. Replace the compartment cover and tighten the four Phillips screws. Do not over-tighten these screws, but make sure they are tight enough to properly seal the gasket.

✓ **Note:** *Discard expired batteries according to local regulations.*

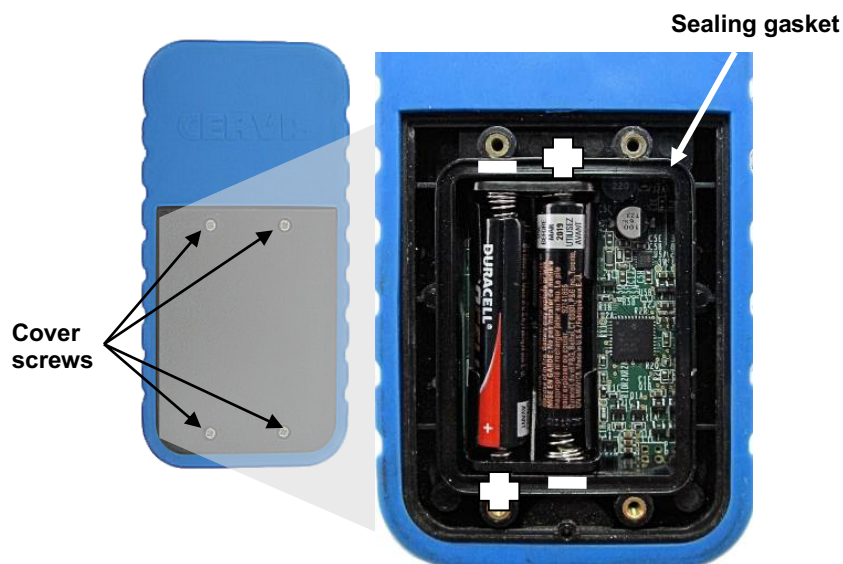

Figure 3 Remote Control Battery Installation

✓ **Note:** *Cover screws must be tight enough to compress the sealing gasket. Do not over-tighten the screws.*

CAUTION



Be sure to observe proper polarity when placing batteries in the remote control battery compartment.

4.0 Using a Standard SmaRT Remote Control Unit

Remote control is achieved under the following conditions:

- Communication between the remote control and base unit must be established. If the remote control and base unit are not communicating while under power, the link must be established using the Associate Procedure (Section 2.1).
- You must be in clear line of sight of the base unit while holding the remote control – usually within approximately 200 m of the unit.

Usually, each button is programmed for a particular assigned function or hardwired output driven by the base unit. The control may be either:

- Momentary, where the command is active only while the button is engaged.
- Latched, where, once pushed, the output or function remains active when the button is released.

Turn the HH-x6P remote control on by pushing and releasing the green **ON** button at the top of the unit. The remote control remains under power until either:

1. The red **OFF** button is pushed.
2. The Inactivity timeout occurs, where no button activity is sensed for a programmed amount of time (default=four minutes).

When the remote control is turned off—and the base unit Safety Link is enabled—all active base unit functions are deactivated.

5.0 Low Battery Warning and Low Battery Auto-Shutdown

At 2.1 VDC and below, the Amber battery (**BAT**) LED begins flashing approximately once per second to indicate a Low Battery Warning. Messages are still being transmitted, and the remote control can still be used; but Cervis, Inc. recommends installing a fresh set of two “AAA” cell batteries as soon as possible.

At 2.0 VDC, the Amber **BAT** LED will turn on solid, and the unit will begin a self power shutdown. The associated device will receive a low-battery power-down message.

✓ **Note:** At 2.0 VDC, the **BAT LED** only lights for approximately 1.25 seconds. Be aware that you can easily miss this brief time. Once the remote control automatically shuts down, the unit will not function properly until a fresh set of two “AAA” cell batteries are installed.

LOW BATTERY

The **BAT** LED begins flashing once per second, indicating that a LOW BATTERY (2.1 V or less) condition is present. Two fresh “AAA” cell batteries should be installed as soon as possible. The LED continues flashing at one-second intervals either unit the batteries are changed, or until the voltage level drops to 2.0 V and Auto-Shutdown occurs.

AUTO-SHUTDOWN

At 2.0 V, the **BAT** LED flashes briefly for approximately 1.25 seconds before the remote control unit automatically shuts down.

Two fresh “AAA” cell batteries must be installed before the transmitter can be used again.

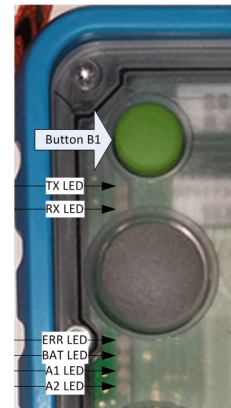

Figure 4 Remote Low Battery Warning and Auto-Shutdown

6.0 Specifications

Table 2 smaRT HH-x6P Remote Control Unit Specifications

Item	Description	
Power	V_{in}	+2.1 V to +3.2 VDC
	Source	Two “AAA” cell batteries
	Auto-shutdown	Four minutes of button inactivity (default)
	Low Battery Warning	≈2.1 V – batteries should be immediately replaced
	Low Battery Shutdown	≤2.0 V – batteries must be replaced to operate
Environment	Operating Temp²	–20° C to 55° C (–4° F to 131° F)
	Storage Temp	–40° C to 55° C (–40° F to 131° F)
	Humidity	0 to 100%
Radio	Frequency	906–924 MHz @ 100 mW (HH-9X6P) 2405–2480 MHz @ 100 mW (HH-2H6P)
	License	None required
	Modulation	DSSS
	Antenna	Internal
Enclosure	Dimensions	mm: 133 x 67 x 35 inches: 5.25 x 2.625 x 1.375
	Total Weight	200 g/7.2 oz (with lanyard or belt clip)
	Durability	High Impact Polymer case Polycarbonate faceplate Impact absorbing bumper
LED Indicators	TX (Green)	Transmit – Flashes when transmitting messages
	RX (Amber)	Receive – Flashes when receiving messages
	ERR (Red)	Error - Indicates when errors are detected
	BAT (Amber)	Battery - Blinks when low battery condition exists
	A1	Used when custom-programmed
	A2	Used when custom-programmed
	D10	Used when custom-programmed, HH-x6P-LED
	D11	Used when custom-programmed, HH-x6P-LED
	D12	Used when custom-programmed, HH-x6P-LED
	D13	Used when custom-programmed, HH-x6P-LED
D14	Used when custom-programmed, HH-x6P-LED	
D15	Used when custom-programmed, HH-x6P-LED	
Buttons	Two	Digital Inputs
	Six	Proportional Inputs

² Sensitivity to proportional buttons may increase as temperature decreases below 0°C. Less force may be required at temperatures below 0°C for a given proportional command than at higher temperatures.

7.0 Spare Parts List

Table 3 Spare Parts List

Item	Cervis, Inc. Bin Location
Protective Rubber Bumper	07127150
Lanyard	15100110
Battery Cover with 4 Attached Screws	Call Cervis, Inc. @ 724-741-9000
AAA 1.5V Cell Batteries (Two-pack)	AA6-03
Belt Clip	AA5-07
Replacement Antenna	Disallowed

Appendix A: Exposure to Radio Frequency Energy

SmaRT remote control units contain radio transceivers. A handheld remote emits radio frequency (RF) energy through its internal antenna while active.

For optimal performance—and to ensure that human exposure to RF energy does not exceed the recommended guidelines—always follow these instructions and precautions.

When using the handheld remote control unit:

- Hold the remote so that the top buttons are away from the body in the direction of the base unit.
- Keep the remote at least 15 mm ($\frac{5}{8}$ inch) away from the body.
- Only use carrying cases, belt clips, or holders approved by Cervis, Inc.

Appendix B: Agency Identification Label Locations

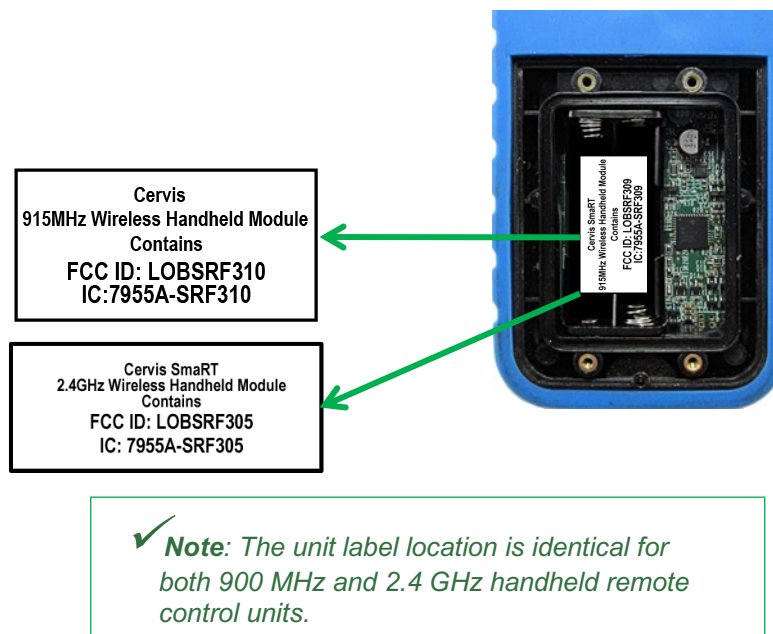

Figure 5 Agency Identification Label Locations

